

1)-From old firmware <= 5.1.0

Run RxUpgrade from RxTools

next

Select connection (select best way to accomplish)

next

select PolaRx5-firmware-5.1.0-OS_failsafe.suf

next

Upgrade

->At finish use back, back to select next file.

select PolaRx5-firmware-5.1.0-full.suf

next

Upgrade

2)-From 5.2.0

->Connect using RxUpgrade or at finish use back, back to select next file.

select PolaRx5-firmware-5.2.0-OS_failsafe.suf

next

Upgrade

->At finish use back, back to select next file.

select PolaRx5-firmware-5.2.0-full.suf

next

Upgrade

3)-From 5.3.2 (See errors and resolution below)

->Connect using RxUpgrade or at finish use back, back to select next file.

select PolaRx5-5.3.2-failsafe.suf

next

Upgrade

->At finish use back, back to select next file.

select PPolaRx5-5.3.2.suf

next

Upgrade

At this point answer Finish and exit and the receiver should be upgraded to 5.3.2.

After the upgrade from 5.2.n to 5.3.n upgrade you may see the following errors.

[0:Fri 2020-02-14 00:33:07] Last shutdown caused by command

[1:Fri 2020-02-14 00:33:07] 5 Lv: Err Ln: 261 readCurrCfg Cannot import cmd:
setBINEXFormatting: Argument 'ObsSignals' is invalid!

[2:Fri 2020-02-14 00:33:07] 5 Lv: Err Ln: 261 readCurrCfg Cannot import cmd:
setSignalTracking: Argument 'Signal' is invalid!

[3:Fri 2020-02-14 00:33:07] 5 Lv: Err Ln: 261 readCurrCfg Cannot import cmd:
setSignalUsage: Argument 'PVT' is invalid!

[4:Fri 2020-02-14 00:33:07] 5 Lv: Err Ln: 261 readCurrCfg Cannot import cmd:
setSignalUsage: Argument 'NavData' is invalid!

These errors are due to some signal name changes and the use the old names in the previous configuration file. The 5.3.2 configuration patch corrects the names and adds all other satellites and signals with the exception of GLOL3.

Use RxControl to apply the patch.

When applying the patch be sure to select "No" Reset SSRC7's settings to default before applying the script?

login if/when prompted.

GoTo File>Upload script

Choose PolaRx5_532-config patch_R1.txt

Select "No" Reset SSRC7's settings to default before applying the script?

OK

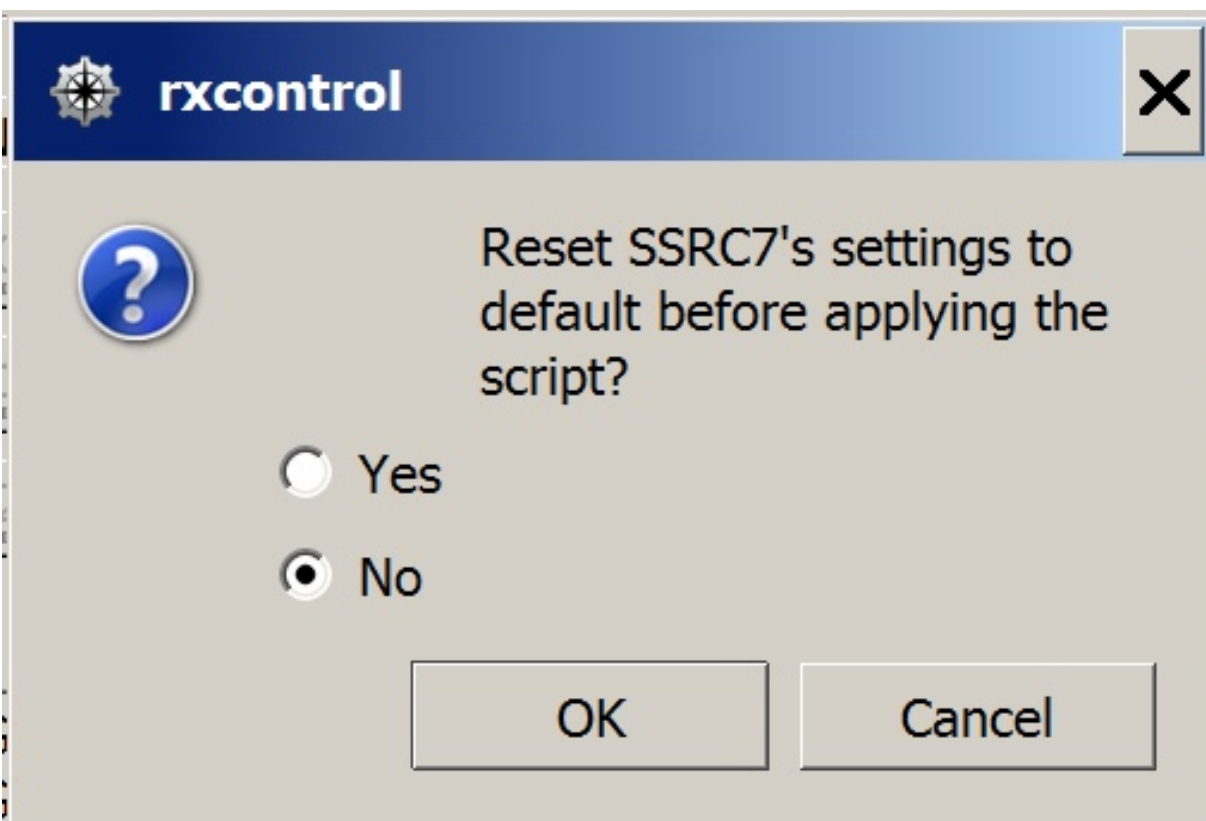

If you fail to check this box the other receiver settings will be cleared. (station position, name, marker, antenna, external sensor)